



CLASSROOM TECHNOLOGY GUIDE

RWU Classroom and Event Support
401-254-6363 option 2
mediatech@rwu.edu

*Art
Lobby*

Roger Williams
University

Information
Technology

In the Samsung display rooms you will find a **Samsung display and remote**, a **Lenovo computer**, a **wireless mouse and keyboard** to use with the Lenovo PC, and a **HDMI connection**.

To power on the display, press the **Red Power button** on the remote. The display will show the last source that was selected.



Using Lenovo PC

To display the Lenovo PC, press the **source** button on the remote. The **source menu** will show on the display screen.

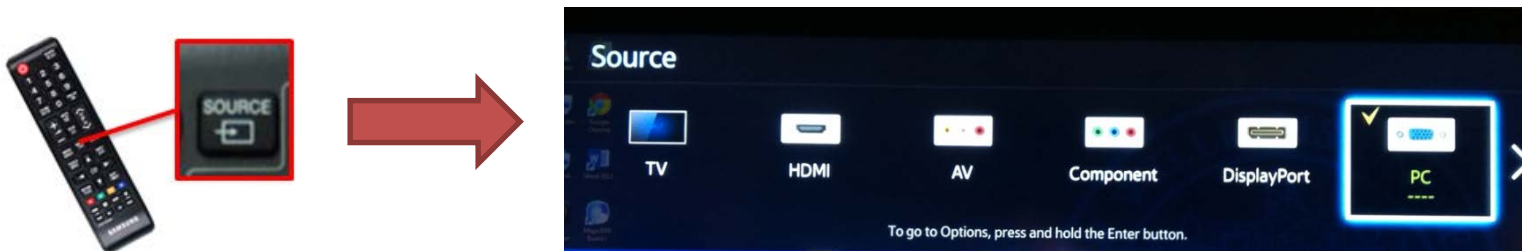

Then, use the ◀▶ arrows on the remote to select **DisplayPort** and hit enter. 



The computer will display on screen.

Button to open disk drive



Power Button

USB Port

If the PC is not powered on, press the **power button** located on the front of the PC. The power button will light up **green** when turned on.

If you wish to play a DVD, there is a disk drive located on the Lenovo PC. To open, press **the Black button** on the disk drive. Insert disk and close. The DVD will load onto the computer automatically.

Connect a laptop

To connect a laptop to the system, use the **HDMI** cord connected to the Samsung display. Plug the HDMI cord into your laptop. Use the thunderbolt adapter if connecting a Mac



To power on the display, press the **Red Power button** on the remote. The display will show the last source that was selected.



Press the **source** button on the remote. The **source menu** will show on the display screen.

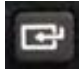

Use the ◀▶ arrows to select **HDMI**. Then, press enter.  The laptop will display on screen.





Using Office Mac

To display the office Mac, make sure the **VGA cord with adapter** is plugged into the Mac Displayport and the audio cord is plugged into the headphone jack. This VGA cord is located on the desk. Do not use the VGA outlet on the wall in the office.

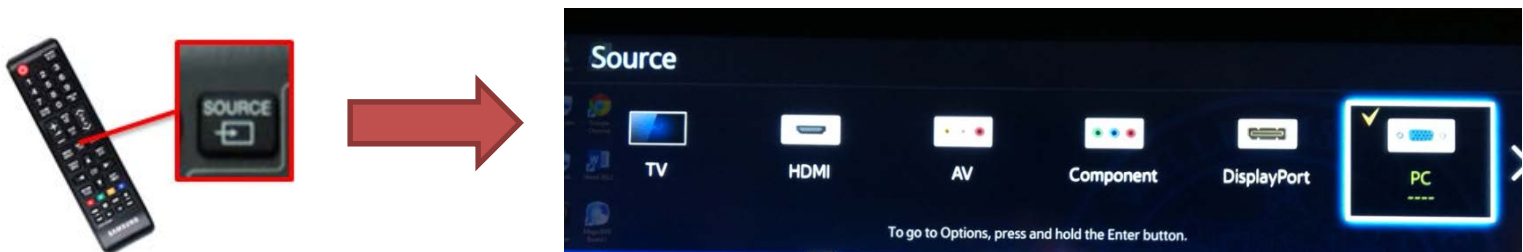

Press the **source** button on the remote. The **source menu** will show on the display screen.



Then, use the ◀▶ arrows on the remote to select **PC** and hit enter. 



The computer will display on screen.

Adjusting Audio

If you need to adjust the volume of the display, simply use the remote **Volume up and down buttons**. The volume level number will appear on the left side of the display.

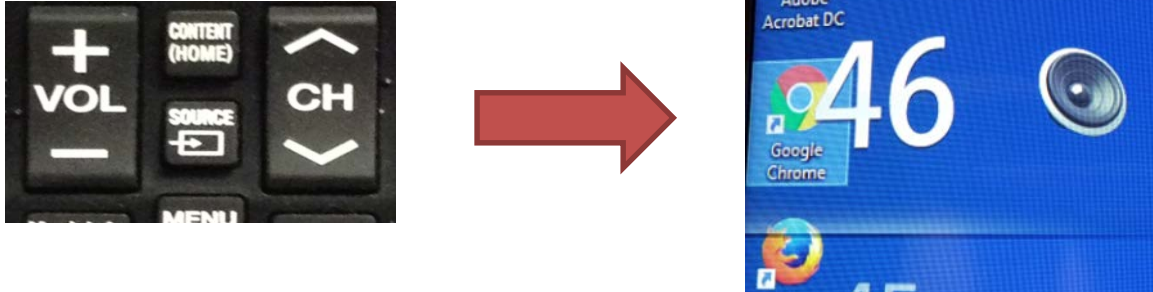

When connecting a laptop, make sure the laptop audio is going to the display. Right click on the **volume icon** located on the lower right corner of the laptop desktop. Click **playback devices**.

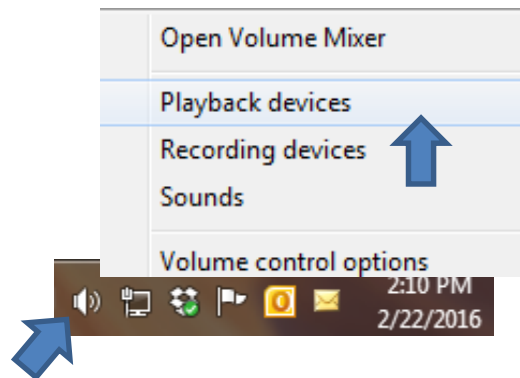

Select **HDMI output**. Click **Set Default**. Click **OK**.

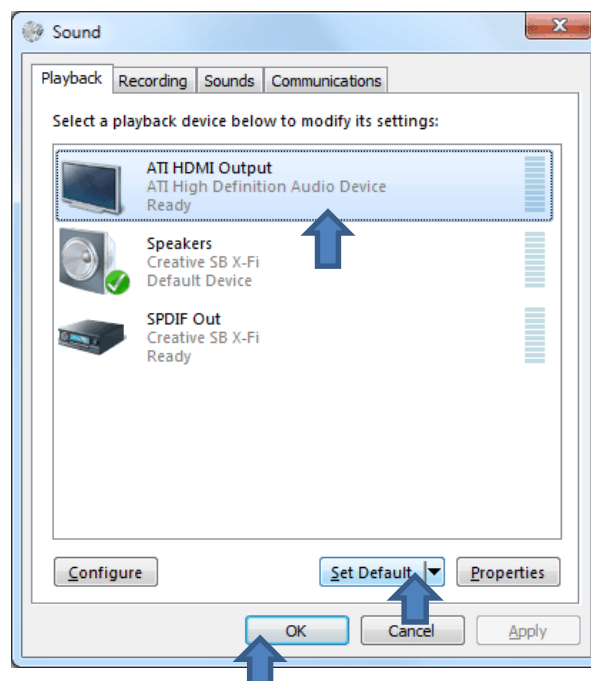

To adjust mac audio, click on **the Apple icon** (🍏). From the drop down menu, select **System Preferences**. From the **System Preferences** menu, click **Sound**.

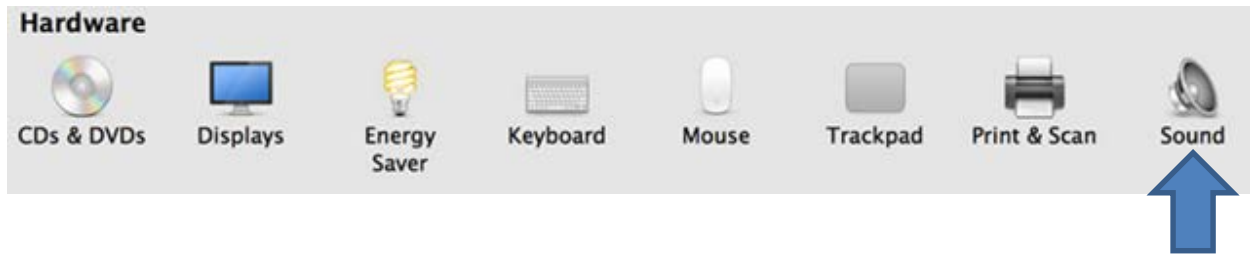

In Sound options, click the **Output** tab and then select the **HDMI** source from the list.

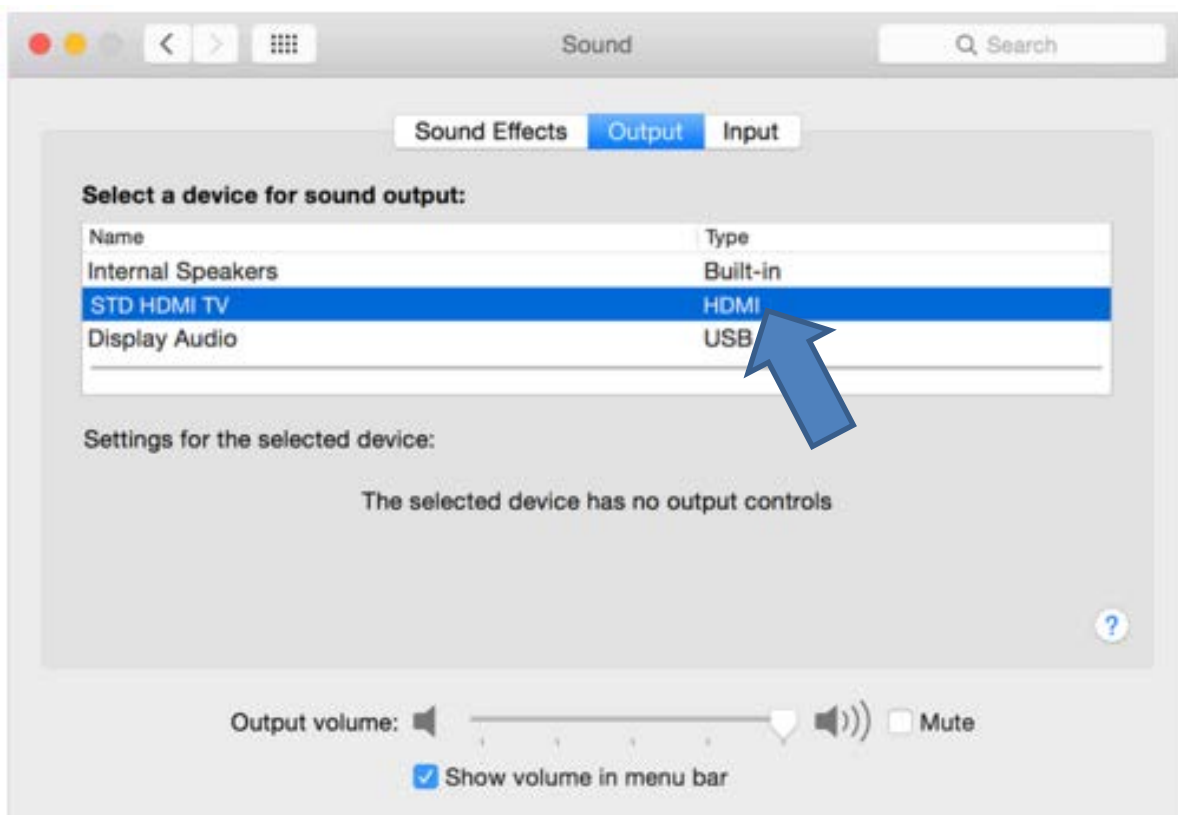

Troubleshooting Display Connection

When you connect a laptop to the display, the computer may be in extended mode. Extended mode is when the computer uses the projector as an extra monitor extending the visual range of the desktop. To correct this issue, Right click on the desktop. From the drop down menu, select **Screen resolution**.

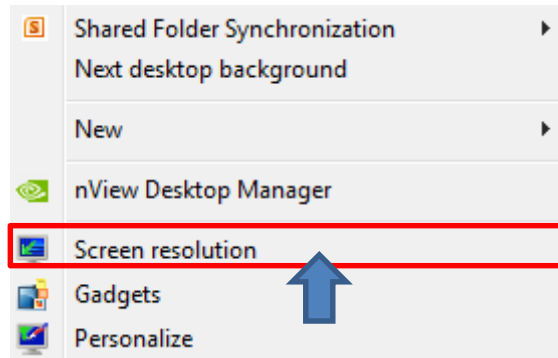

In **Screen resolution** you will find different display options. Under the **Multiple displays** drop down menu, select **Duplicate these displays**. Then, click **Apply**.

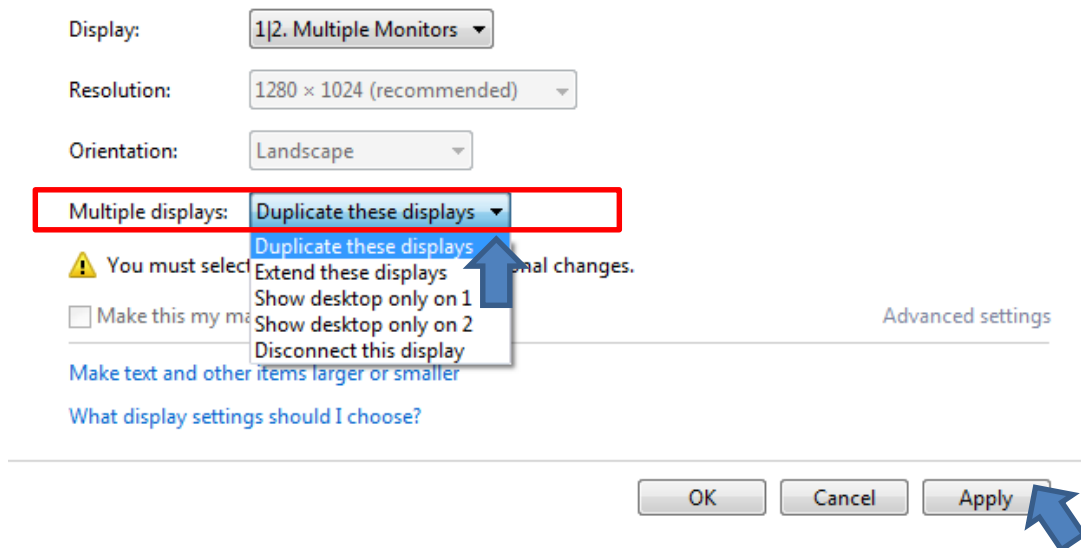

A box will appear on screen asking if you want to keep these display settings. Click **Keep changes**. The computer is now in duplicate mode. The projected image will now mirror your computer.

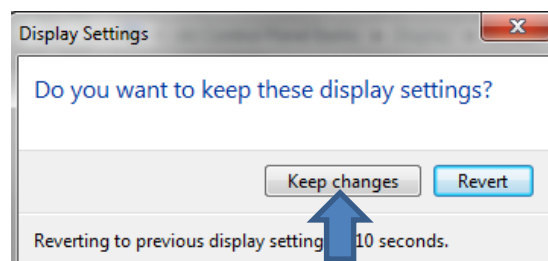

When connecting your Mac, click on **the Apple icon** (🍏). From the drop down menu, select **System Preferences**. From the **System Preferences** menu, click **Displays**.

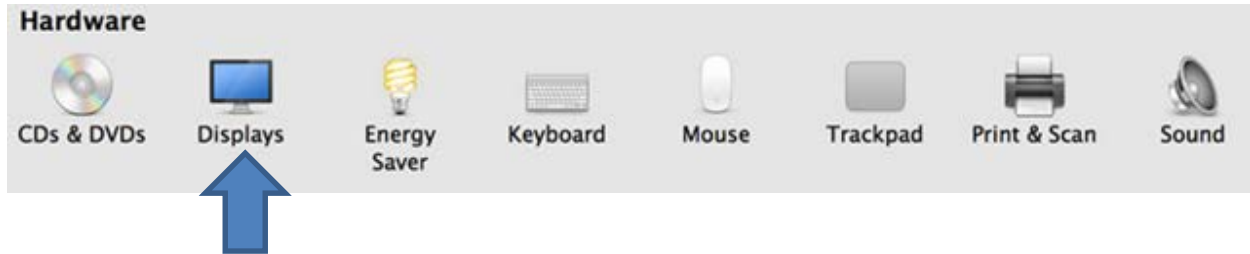

In display options, select the **Arrangement** tab. Check the **Mirror Displays** box. The projected image will now mirror your computer.

